

# Self Adjusting Clutch Alignment Setting Tool Set

## 9AK21

- Prevent damage to system and to keep adapter ring in right position
- Necessary for pre-tensioning self adjusting clutches before removal or installation, avoiding clutch deformation
- Prevents plate distortion
- Suitable for most SAC(Self Adjusting Clutches 3 and 4 holes) equipped on vehicles of FIAT GROUP, VW-AUDI, BMW, MERCEDES, VOLVO, OPEL, RENAULT etc

10.75 1 / 2

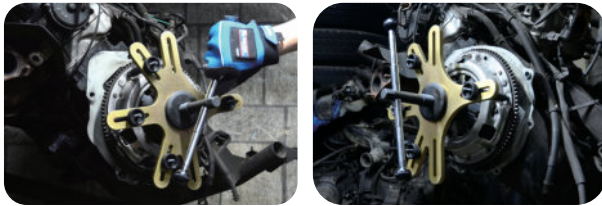

38 PC.

# Pulley Removing Wrench

## 9AL

- To lock the pulley during removing or assembling any type of pulley retaining bolt

KT NO.	inch	L mm	∅ mm	kg	1 / 2
9AL11	14-3/8	365	40~140	540	12 / 36
9AL12	14-3/8	365	40~140	540	12 / 36

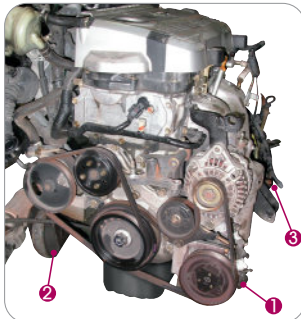
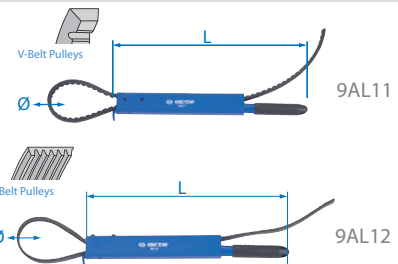

• Compressors



• Water pump pulley



• Alternator pump pulley



• Oil filter removal & assembly

# Universal Cooling Pump and Refiller Tool Set



CAUTION

DO NOT open the radiator cap on a hot engine

## 9AM01

- For testing leakage in radiator system
- Vacuum leakage testing and bubble-free refilling
- Special pick hooks to speed up replacement of pipes
- Quick-release coupling on each connections
- Rubber cones with functional diameter 17~40mm

KT NO.	Type	kg	1 / 2
9AM010	Japan	3.40	1 / 5
9AM011	USA	3.40	1 / 5
9AM012	Europe	3.40	1 / 5

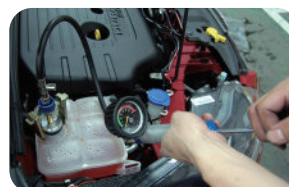
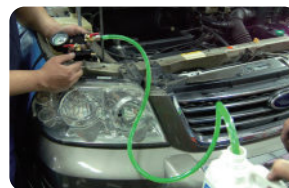

7 PC.