

LAND ROVER

Diesel Injection Pump Puller

9AT2-D01

- Specifically designed for holding the sprocket / chain in place when disassembling the VP44 injection pump and high pressure pump
- Common rail fits BMW engines

528   6 / 36

MODEL: Freelande r (00-06)
Td4 (2.0cd)
Range Rover (02-06)
Td6 (3.0cd)

ENGINE CODE: 204D3 / Td4
(2.0 M47:BMW)
306D1 / Td6
(3.0 M57 : BMW)

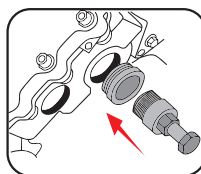

RENAULT

Diesel Engine Setting & Locking Set

9AT2008E

- The set includes auxiliary belt tensioner locking pin, camshaft setting tools, crankshaft pulley holding tool, chain tensioner locking pin and crankshaft locking pin
- Suitable for 2.0 dCi chain drive engines of Renault, Nissan and Vauxhall / Opel

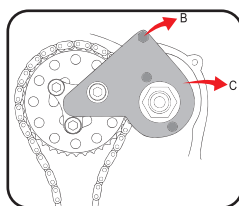
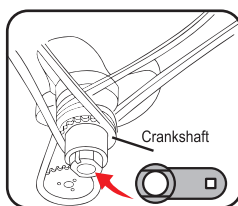

2376   1 / 5

MODEL: Megane II (07-09)
Scenic / Grand Scenic (08-09)
Laguna II (01-05)
Vel Satis (05-09)
Espace / Grand Espace (08-09)
Koleos (08-09)
Trafi c (07-09)

ENGINE CODE: 2,0 dCi M9R
700, 721, 722, 724, 740, 742, 746, 760
761, 780, 802, 803, 805, 830, 832, 833

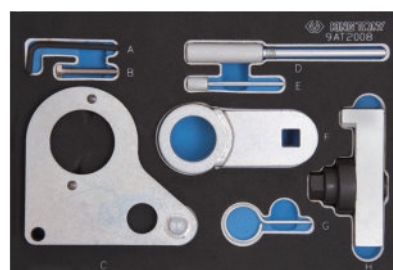

CONTENTS :

- A&H - camshaft gear alignment tool
- B&C - camshaft setting plate
- D - crankshaft locking pin
- E - auxiliary belt tensioner locking pin
- F - crankshaft pulley holding tool
- G - chain tensioner locking pin

