

Petrol Engine Flywheel Holding Tool

9AT1-E01

- Use to lock the flywheel while removing and replacing the timing belt
- Put it into the teeth of the flywheel to hold the crankshaft up, while releasing or tightening the bolt

 51  /  20 / 100

MODEL: **Delta** (96-99)
Lybra (99-06)

ENGINE CODE: 182A4.000
182A6.000

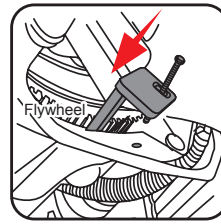

LAND ROVER

Diesel Engine 2.0 / 3.0 Timing Set

9AT2007E

- The set includes camshaft setting plate, tensioner retaining pin set and flywheel locking pin
- Suitable for BMW 2.0 and 3.0 liters common rail diesel engines in BMW 3, 5 & 7 Series, X5, Land Rover Freelander, Range Rover, Rover 75, Vauxhall / Opel
- Use to check and adjust the timing position of camshaft and TDC position of crankshaft

 1753  /  1 / 10

MODEL: **Diesel (Chain)**
Freelander (00-06)
Td4 (2.0d)
Range Rover (02-06)
Td6 (3.0d)

ENGINE CODE: **Diesel (Chain)**
204D3 / Td4
(2.0 M47:BMW)
306D1 / Td6
(3.0 M27:BMW)

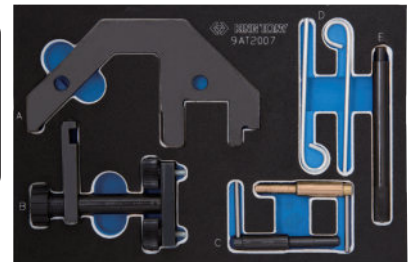
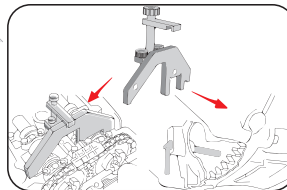

CONTENTS :

- A – camshaft setting plate
- B – camshaft plate locking tool
- C – TDC timing pin
- D – tensioner retaining pin set (pair)
- E – flywheel locking pin



Diesel Engine 2.5TDS Timing Set

9AT2106E

- The set includes camshaft setting plate, tensioner lever, tensioner retaining pin, flywheel locking pin and pump remove & sprocket retainer
- Suitable for BMW, Land Rover and Opel engines
- Use to retain and support the sprocket and timing chains in position when the pump is removed

 2480  /  1 / 5

MODEL: **2.5D Turbo (Chain)**
Range Rover (94-02)

ENGINE CODE: 256T M51

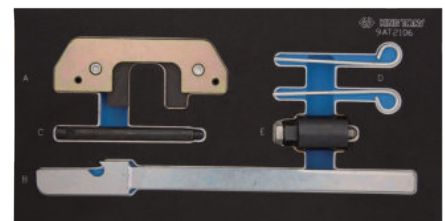
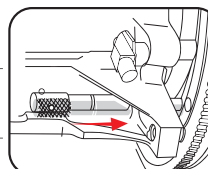
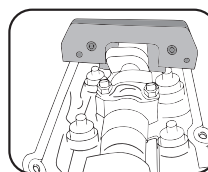

CONTENTS :

- A – camshaft setting plate
- B – tensioner lever
- C – flywheel locking pin
- D – tensioner retaining pin
- E – pump remove & sprocket retainer (2 part)

