

# Heavy Duty Adjustable Torque Wrench

Design for easy torque adjustment

Quality accords to DIN ISO 6789:2017 & ASME B107.300-2010

Tolerance of torque  $\pm 3\%$ (CW)

CW/CCW Direction

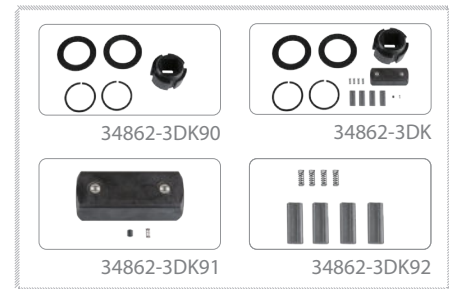
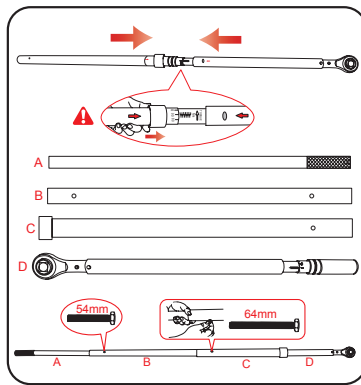
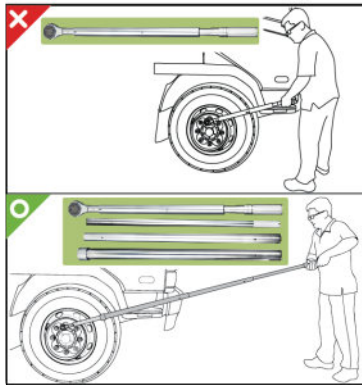

Dual Scale - English & Newton Meter (ft-lb & N-m)

KT NO.	Square drive	Torque range ft-lb	Incr.	Torque range N-m	Incr.	Overall length mm	kg	Box
34862-3CF	1"	400~2000	10 ft-lb	610~2644	13.55 N-m	2755	23.99	1 / 1
KT NO.	Square drive	Torque range N-m	Incr.	Torque range ft-lb	Incr.	Overall length mm	kg	Box
34862-3FF	1"	500~2500	20 N-m	443~1771	14.77 ft-lb	2755	25.38	1 / 1

# Heavy Duty Mini-type Torque Wrench

Industrial application

Quality accords to DIN ISO 6789:2017 & ASME B107.300-2010

Tolerance of torque  $\pm 3\%$ (CW)

CW/CCW Direction

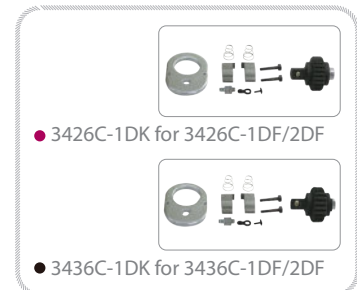

Single scale - Newton Meter (N-m)

KT NO.	Square drive	Torque range N-m	Incr.	Overall length mm	kg	Box
3426C-1DF	1/4"	3~15	0.1 N-m	211	330	24
3426C-2DF	1/4"	5~25	0.2 N-m	249	430	24
3436C-1DF	3/8"	3~15	0.1 N-m	211	450	24
3436C-2DF	3/8"	5~25	0.2 N-m	249	550	24