

# Impact Bit Socket Set

**4407MP**

1/2"

- For hexagon head screw
- 60mmL
- Metal case size (mm) :  
198 x 105 x 32 (0.023 cuft)



7  
PC.

Contents

0.94 / 1 / 20

4055M H4, H5, H6, H8, H10, H12, H14

**4457MP**

1/2"

- For hexagon head screw
- 100mmL
- Metal case size (mm) :  
244 x 118 x 37 (0.038 cuft)



7  
PC.

Contents

1.44 / 1 / 18

4065M H4, H5, H6, H8, H10, H12, H14

**4476MP**

1/2"

- For hexagon head screw
- 150mmL
- Metal case size (mm) :  
244 x 118 x 37 (0.038 cuft)



6  
PC.

Contents

1.47 / 1 / 18

4075M H5, H6, H8, H10, H12, H14

**4418MP**

1/2"

- For hexagon head screw
- 60mmL
- Metal case size (mm) :  
270 x 73 x 46 (0.032 cuft)



8  
PC.

Contents

1.34 / 1 / 20

4055M H5, H6, H8, H10, H12, H14, H17, H19

**4417PP**

1/2"

- For torx internal screw
- 60mmL
- Metal case size (mm) :  
198 x 105 x 32 (0.023 cuft)



7  
PC.

Contents

0.94 / 1 / 20

4053 T25, T30, T40, T45, T50, T55, T60

**4467PP**

1/2"

- For torx internal screw
- 100mmL
- Metal case size (mm) :  
244 x 118 x 37 (0.038 cuft)



7  
PC.

Contents

1.31 / 1 / 18

4063 T25, T30, T40, T45, T50, T55, T60

## Standard Impact Socket

KT No. & D1



**6510M**

3/4"

- Lightweight type
- DIN 3121

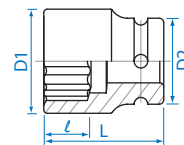

KT NO.	mm	D1 mm	D2 mm	l mm	L mm		/
651017M	17	29.0	38	10	50	225	8 / 96
651018M	18	30.0	38	10	50	230	8 / 96
651019M	19	32.0	38	10	50	240	8 / 96
651021M	21	35.0	38	13	50	252	8 / 96
651022M	22	36.0	38	13	50	255	8 / 96
651023M	23	37.0	38	15	50	256	8 / 96
651024M	24	38.0	38	15	50	265	8 / 96
651026M	26	38.0	38	15	53	257	6 / 48
651027M	27	42.0	38	18	53	299	6 / 48
651028M	28	44.0	38	18	53	325	6 / 48
651029M	29	45.0	38	18	53	330	6 / 48
651030M	30	46.0	38	20	53	337	6 / 48