

# Impact Universal Joint Socket

**4B55M** **4B55S**  $\frac{1}{2}$ "

- Special design for confined spaces
- DIN 3121

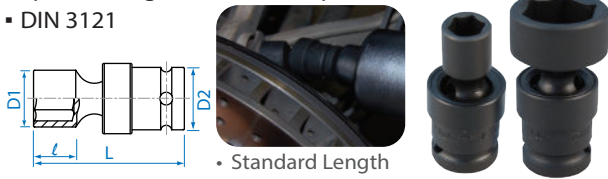

• Standard Length

KT NO.	mm	D1 mm	D2 mm	l mm	L mm	g	kg	Box
4B5510M	10	17.0	27.5	12	64	167	10 / 120	
4B5511M	11	19.0	27.5	12	64	166	10 / 120	
4B5512M	12	19.0	27.5	12	64	165	10 / 120	
4B5513M	13	21.8	27.5	12	64	171	10 / 120	
4B5514M	14	22.0	27.5	12	64	178	10 / 120	
4B5515M	15	22.0	27.5	12	64	175	10 / 120	
4B5516M	16	23.9	27.5	12	64	182	10 / 120	
4B5517M	17	25.0	27.5	12	64	190	10 / 120	
4B5521M	21	30.0	27.5	12	64	202	10 / 120	
4B5522M	22	31.7	27.5	12	64	208	10 / 120	

KT NO.	Inch	D1 mm	D2 mm	l mm	L mm	g	kg	Box
4B5512S	3/8	17.0	27.5	12	64	161	10 / 120	
4B5514S	7/16	19.0	27.5	12	64	166	10 / 120	
4B5516S	1/2	21.8	27.5	12	64	176	10 / 120	
4B5518S	9/16	22.0	27.5	12	64	174	10 / 120	
4B5520S	5/8	23.9	27.5	12	64	180	10 / 120	
4B5522S	11/16	25.0	27.5	12	64	173	10 / 120	
4B5526S	13/16	30.0	27.5	12	64	190	10 / 120	
4B5528S	7/8	31.7	27.5	12	64	196	10 / 120	
4B5530S	15/16	35.8	27.5	12	64	217	6 / 96	

# Impact Accessory

**4147**  $\frac{1}{2}$ "

- Bit holder
- DIN 3121



KT NO.	Size	Overall length mm	g	kg	Box
414708S	1/4"	48	73	12 / 216	
414710S	5/16"	48	79	12 / 216	
414710M	10 mm	48	79	12 / 216	

**414A08S**  $\frac{1}{2}$ "

- Quick-release
- Bit holder
- DIN 3121



KT NO.	Size	Overall length mm	g	kg	Box
414A08S	1/4"	51.2	68	10 / 180	

**4260P**  $\frac{1}{2}$ "

- Extension bar
- DIN 3121



KT NO.	Overall length Inch	Overall length mm	g	kg	Box
4260-03P	3	75	198	4 / 80	
4260-04P	4	100	240	4 / 80	
4260-05P	5	125	278	2 / 40	
4260-06P	6	150	324	4 / 80	
4260-08P	8	200	402	4 / 48	
4260-10P	10	250	487	4 / 48	
4260-12P	12	300	573	2 / 40	
4260-16P	16	400	746	2 / 20	

# Impact Bit Socket

KT No. & D1



- Air pressure must not exceed 90PSI (6.3bar)
- Adjust your air tool to its lowest torque output, should this torque level not be enough, increase it gradually

**1740**  $\frac{1}{2}$ " **409616M**  $\frac{1}{2}$ "

- Hex bit & bit holder
- DIN 3121

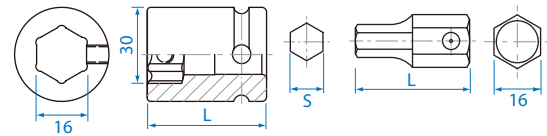

KT NO.	mm	L mm	Max. torq N-m	g	kg	Box
174010H	H10	40	264.0	46	20 / 400	
174012H	H12	40	480.0	52	20 / 400	
174014H	H14	40	684.0	60	20 / 200	
174017H	H17	40	680.0	73	20 / 200	
174019H	H19	40	680.0	80	20 / 200	
174022H	H22	40	680.0	97	12 / 120	
409616M	16	38	680.0	145	10 / 160	

**4065M**  $\frac{1}{2}$ "

- Hexagon head
- DIN 3121



KT NO.	mm	L mm	Max. torq N-m	g	kg	Box
406504M	H4	100	20.8	73	6 / 120	
406505M	H5	100	36.0	78	6 / 120	
406506M	H6	100	62.4	85	6 / 120	
406508M	H8	100	144.0	95	6 / 120	
406510M	H10	100	264.0	114	6 / 120	
406512M	H12	100	480.0	138	6 / 120	
406514M	H14	100	650.0	164	6 / 120	

**4075M**  $\frac{1}{2}$ "

- Hexagon head
- DIN 3121



KT NO.	mm	L mm	Max. torq N-m	g	kg	Box
407505M	H5	150	36.0	115	6 / 120	
407506M	H6	150	62.4	115	6 / 120	
407508M	H8	150	144.0	116	6 / 120	
407510M	H10	150	264.0	148	6 / 120	
407512M	H12	150	480.0	187	6 / 120	
407514M	H14	150	650.0	231	6 / 120	