

# Stubby Impact Socket

4525M

1/2"

- For impact wrench use
- DIN 3129, ISO 2725-2

19, 22, 24 mm

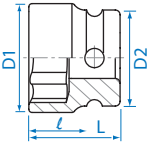

| KT NO.  | mm | D1 mm | D2 mm | ℓ mm | L mm | g  | kg       |
|---------|----|-------|-------|------|------|----|----------|
| 452513M | 13 | 20    | 26    | 5.5  | 28.5 | 57 | 10 / 160 |
| 452514M | 14 | 22    | 26    | 5.5  | 28.5 | 61 | 10 / 160 |
| 452517M | 17 | 26    | 26    | 5.5  | 28.5 | 64 | 10 / 160 |
| 452519M | 19 | 28    | 26    | 10   | 28.5 | 63 | 10 / 160 |
| 452521M | 21 | 30    | 30    | 10   | 28.5 | 81 | 8 / 160  |
| 452522M | 22 | 32    | 30    | 10   | 28.5 | 87 | 8 / 160  |
| 452524M | 24 | 34    | 30    | 10   | 28.5 | 80 | 6 / 120  |

# Standard Impact Socket

4535M

1/2"

- DIN 3129, ISO 2725-2

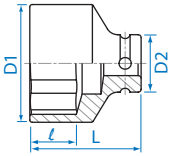

| KT NO.  | mm | D1 mm | D2 mm | ℓ mm | L mm | g   | kg       |
|---------|----|-------|-------|------|------|-----|----------|
| 453508M | 8  | 15.0  | 25    | 7    | 38   | 67  | 10 / 200 |
| 453509M | 9  | 16.3  | 25    | 7    | 38   | 69  | 10 / 200 |
| 453510M | 10 | 17.6  | 25    | 8    | 38   | 70  | 10 / 200 |
| 453511M | 11 | 18.8  | 25    | 8    | 38   | 71  | 10 / 200 |
| 453512M | 12 | 20.0  | 25    | 9    | 38   | 73  | 10 / 200 |
| 453513M | 13 | 21.2  | 25    | 10   | 38   | 75  | 10 / 200 |
| 453514M | 14 | 22.5  | 25    | 10   | 38   | 78  | 10 / 200 |
| 453515M | 15 | 23.8  | 30    | 11   | 38   | 117 | 10 / 160 |
| 453516M | 16 | 25.0  | 30    | 11   | 38   | 118 | 10 / 160 |
| 453517M | 17 | 26.2  | 30    | 12   | 38   | 121 | 10 / 160 |
| 453518M | 18 | 27.5  | 30    | 13   | 38   | 123 | 10 / 160 |
| 453519M | 19 | 28.8  | 30    | 13   | 38   | 117 | 10 / 160 |
| 453520M | 20 | 29.5  | 30    | 13   | 38   | 115 | 10 / 160 |
| 453521M | 21 | 30.0  | 30    | 14   | 40   | 118 | 8 / 160  |
| 453522M | 22 | 31.8  | 30    | 14   | 40   | 132 | 8 / 160  |
| 453523M | 23 | 33.8  | 30    | 15   | 40   | 144 | 8 / 160  |
| 453524M | 24 | 33.8  | 30    | 15   | 42   | 139 | 6 / 120  |
| 453525M | 25 | 35.8  | 30    | 15   | 42   | 156 | 6 / 120  |
| 453526M | 26 | 37.8  | 30    | 15   | 42   | 173 | 6 / 120  |
| 453527M | 27 | 38.0  | 30    | 16   | 44   | 175 | 6 / 120  |
| 453528M | 28 | 41.0  | 30    | 16   | 44   | 204 | 6 / 120  |
| 453529M | 29 | 41.0  | 30    | 17   | 44   | 198 | 6 / 120  |
| 453530M | 30 | 42.0  | 30.5  | 17   | 44   | 206 | 6 / 120  |
| 453532M | 32 | 46.0  | 30    | 19   | 44   | 239 | 6 / 120  |
| 453533M | 33 | 46.0  | 30    | 19   | 46   | 246 | 6 / 96   |
| 453534M | 34 | 46.0  | 30    | 20   | 46   | 240 | 6 / 96   |
| 453535M | 35 | 46.0  | 30    | 20   | 46   | 227 | 6 / 96   |
| 453536M | 36 | 47.0  | 30    | 20   | 46   | 243 | 6 / 96   |
| 453537M | 37 | 49.0  | 30    | 21   | 48   | 271 | 6 / 60   |

| KT NO.  | mm | D1 mm | D2 mm | ℓ mm | L mm | g   | kg     |
|---------|----|-------|-------|------|------|-----|--------|
| 453538M | 38 | 50.0  | 30    | 21   | 50   | 291 | 6 / 60 |
| 453539M | 39 | 51.0  | 30    | 22   | 50   | 306 | 6 / 60 |
| 453541M | 41 | 56.0  | 30    | 22   | 52   | 403 | 6 / 60 |
| 453546M | 46 | 64.0  | 30    | 23   | 55   | 595 | 4 / 32 |

4535S

1/2"

- ANSI / ASME B107.2

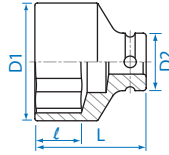

| KT NO.  | inch   | D1 mm | D2 mm | ℓ mm | L mm | g   | kg       |
|---------|--------|-------|-------|------|------|-----|----------|
| 453510S | 5/16   | 15    | 25    | 7    | 38   | 66  | 10 / 200 |
| 453512S | 3/8    | 17    | 25    | 7    | 38   | 70  | 10 / 200 |
| 453514S | 7/16   | 18    | 25    | 8    | 38   | 70  | 10 / 200 |
| 453516S | 1/2    | 20    | 25    | 10   | 38   | 72  | 10 / 200 |
| 453518S | 9/16   | 22    | 25    | 10   | 38   | 77  | 10 / 200 |
| 453520S | 5/8    | 24    | 25    | 11   | 38   | 80  | 10 / 160 |
| 453522S | 11/16  | 26    | 30    | 12   | 38   | 116 | 10 / 160 |
| 453524S | 3/4    | 28.8  | 30    | 13   | 38   | 116 | 10 / 160 |
| 453526S | 13/16  | 30    | 30    | 14   | 40   | 127 | 8 / 160  |
| 453528S | 7/8    | 32    | 30    | 14   | 40   | 136 | 8 / 160  |
| 453530S | 15/16  | 34    | 30    | 15   | 42   | 152 | 6 / 120  |
| 453532S | 1      | 36    | 30    | 15   | 42   | 164 | 6 / 120  |
| 453534S | 1-1/16 | 38    | 30    | 16   | 44   | 180 | 6 / 120  |
| 453536S | 1-1/8  | 41    | 30    | 17   | 44   | 199 | 6 / 120  |
| 453538S | 1-3/16 | 42    | 30.5  | 17   | 44   | 208 | 6 / 120  |
| 453540S | 1-1/4  | 46    | 30    | 18   | 44   | 237 | 6 / 120  |

# Impact Socket Set

4472MP

4472SP

1/2"

- Standard impact socket
- Stand size (mm) : 415 x 336 x 320



| KT NO. | PC. | Contents | Each Q'ty                  |   |
|--------|-----|----------|----------------------------|---|
| 4472MP | 158 |          | 8, 9, 10, 11, 12, 13, 14   | 8 |
|        |     |          | 15, 16, 17, 18, 19, 20, 21 | 6 |
|        |     |          | 22, 23, 24                 | 7 |
|        |     |          | 25, 26, 27, 28             | 6 |
|        |     |          | 29, 30, 32                 | 5 |
| 4472SP | 106 |          | 5/16, 3/8, 7/16, 1/2, 9/16 | 8 |
|        |     |          | 5/8, 11/16, 3/4, 13/16     | 6 |
|        |     |          | 7/8, 15/16,                | 7 |
|        |     |          | 1, 1-1/16, 1-1/8           | 6 |
|        |     |          | 1-3/16, 1-1/4              | 5 |

| KT NO.   | Spec.                  | kg    | Cuft |
|----------|------------------------|-------|------|
| 4472MP-A | 87103                  | 6.37  | 0.67 |
| 4472MP-D | 158 PC. socket content | 19.63 | 0.54 |
| 4472SP-A | 87103                  | 6.37  | 0.67 |
| 4472SP-D | 106 PC. socket content | 20.4  | 0.37 |