

Ratchet

- Material
 - chrome vanadium alloy steel handle
 - chrome molybdenum steel (gear) driver

- Finishing
 - polished, chrome plated
 - black driver by phosphate sunk

KT No. & D1



2725

FINE GEAR

1/4"

- Reversible ratchet
- 8° gear action degree (45 teeth)

KT NO.	Overall length			
	inch	mm		
2725-55F	5-1/2	140	144	5 / 90
2725-55G	5-1/2	140	171	5 / 90
2725DK	renewal kits		-	-



2755

FINE GEAR

1/4"

- Reversible ratchet
- 5° gear action degree (72 teeth)
- DIN3122

KT NO.	Overall length			
	inch	mm		
2755-55G	5-1/2	140	109	5 / 90
2755DK	renewal kits		-	-

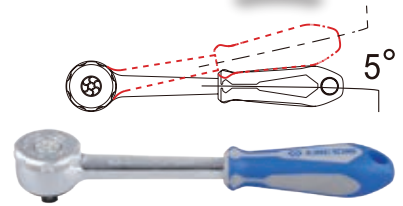

2756

new

FINE GEAR

1/4"

- Quick release reversible ratchet
- 5° gear action degree (72 teeth)
- DIN3122

KT NO.	Overall length			
	inch	mm		
2756-55G	5-1/2	140	120.0	5 / 90
2756DK	renewal kits		-	-

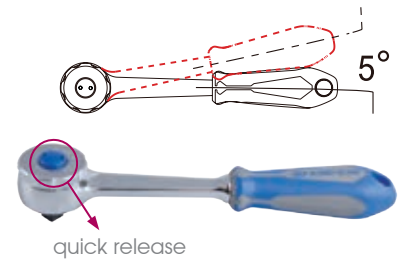

2752

FINE GEAR

1/4"

- Quick release flexible and reversible ratchet
- 5° gear action degree (72 teeth)
- Multi-angle design for difficult-to-reach fasteners

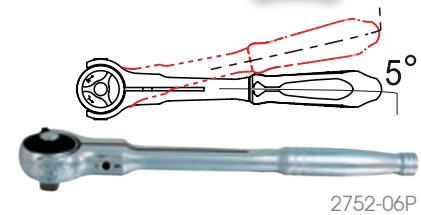
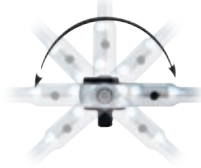

KT NO.	Overall length			
	inch	mm		
2752-06P	6	150	141	6 / 108
2752-06G	6	150	127	6 / 108
2752DK	renewal kits		-	-



2752-45G

FINE GEAR

1/4"

- Swivel head ratchet
- Quick release flexible and reversible ratchet
- 5° gear action degree (72 teeth)
- Application: T-handle ratchet / screwdriver ratchet



KT NO.	Overall length			
	inch	mm		
2752-45G	4-1/2	114	123.8	6 / 108

